

ms Eurodam

DECK PLANS & STATEROOMS

The deck plans are color-coded by category of stateroom, and the category letter precedes the stateroom number in each room. All staterooms are equipped with flat-panel television, mini-bar, DVD player, mini-safe, data port, telephone and multichannel music.

Important Note: Not all staterooms within each category have the same furniture configuration and/or facilities. Appropriate symbols within the rooms on the deck plans describe differences from the stateroom descriptions below.

All information is subject to change.

STATEROOM SYMBOL LEGEND

- Triple (2 lower beds, 1 sofa bed)
- Quad (2 lower beds, 1 sofa bed, 1 upper)
- △ Partial sea view
- × Fully obstructed view
- + Connecting rooms
- * Shower only
- ♣ Single sink vanity, bathtub only
- ♠ Single sink vanity
- ◆ Staterooms have solid steel verandah railings instead of clear-view Plexiglas® railings
- ♿ Staterooms SA7058 and SA7057 are wheelchair accessible, bathtub and roll-in shower. Staterooms V8119, V8116, I-8033, V8026, V8025, VB6052, VB6049, VA6002, VA6001, VF5140, VF5135, VF5054, VF5051, SY5002, SY5001, VD4134, VD4131, H4092, H4089, VD4052, VD4051, D1100, D1099, C1082, C1081, J1074, N1012 & N1011 are wheelchair accessible, roll-in shower only.

OCEAN-VIEW STATEROOMS

C **D** **DD** **E** **F**

Large: 2 lower beds convertible to 1 queen-size bed, bathtub & shower.
Approximately 169–267 sq. ft.

INTERIOR STATEROOMS

J **K**

Large or Standard: 2 lower beds convertible to 1 queen-size bed, shower.
Approximately 141–284 sq. ft.

N

Standard: 2 lower beds convertible to 1 queen-size bed, shower.
Approximately 141–284 sq. ft.

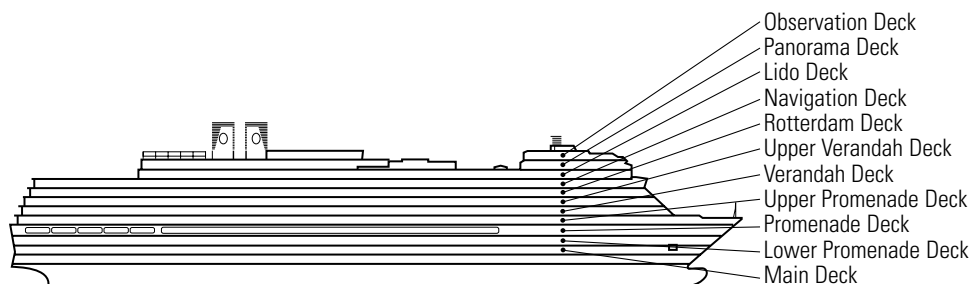

DECK 1 – MAIN DECK

Staterooms 1001–1130

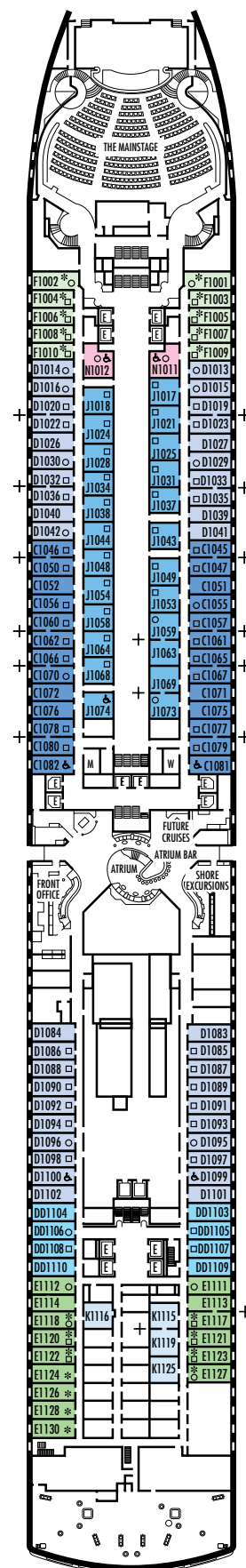

ms Eurodam

DECK PLANS & STATEROOMS

The deck plans are color-coded by category of stateroom, and the category letter precedes the stateroom number in each room. All staterooms are equipped with flat-panel television, mini-bar, DVD player, mini-safe, data port, telephone and multichannel music.

Important Note: Not all staterooms within each category have the same furniture configuration and/or facilities. Appropriate symbols within the rooms on the deck plans describe differences from the stateroom descriptions below.

All information is subject to change.

STATEROOM SYMBOL LEGEND

- Triple (2 lower beds, 1 sofa bed)
- Quad (2 lower beds, 1 sofa bed, 1 upper)
- △ Partial sea view
- × Fully obstructed view
- + Connecting rooms
- * Shower only
- ♣ Single sink vanity, bathtub only
- ♠ Single sink vanity
- ◆ Staterooms have solid steel verandah railings instead of clear-view Plexiglas® railings
- ♿ Staterooms SA7058 and SA7057 are wheelchair accessible, bathtub and roll-in shower. Staterooms V8119, V8116, I-8033, V8026, V8025, VB6052, VB6049, VA6002, VA6001, VF5140, VF5135, VF5054, VF5051, SY5002, SY5001, VD4134, VD4131, H4092, H4089, VD4052, VD4051, D1100, D1099, C1082, C1081, J1074, N1012 & N1011 are wheelchair accessible, roll-in shower only.

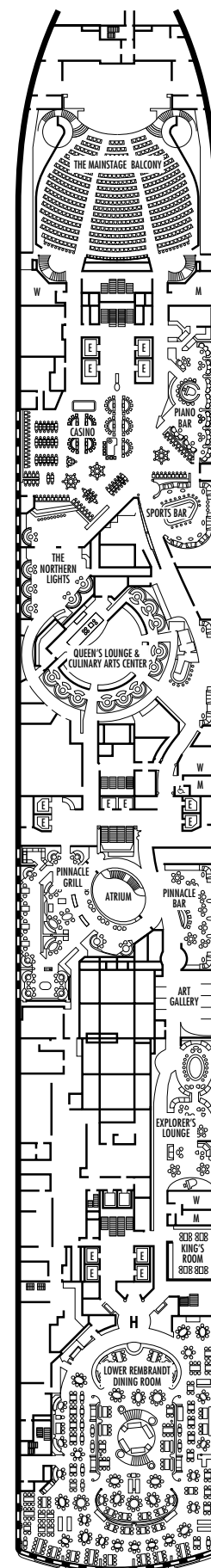
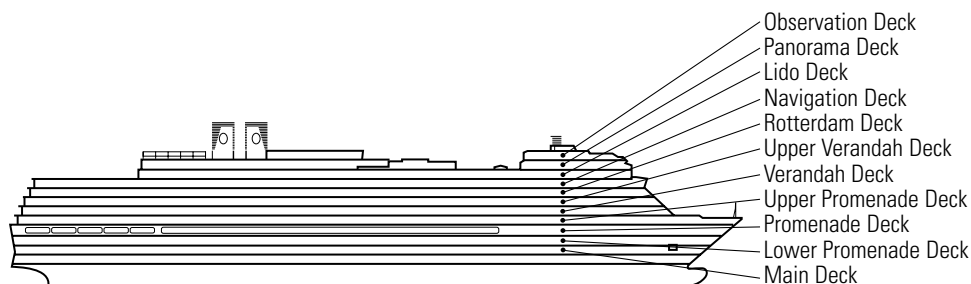

ms Eurodam

DECK PLANS & STATEROOMS

The deck plans are color-coded by category of stateroom, and the category letter precedes the stateroom number in each room. All staterooms are equipped with flat-panel television, mini-bar, DVD player, mini-safe, data port, telephone and multichannel music.

Important Note: Not all staterooms within each category have the same furniture configuration and/or facilities. Appropriate symbols within the rooms on the deck plans describe differences from the stateroom descriptions below.

All information is subject to change.

STATEROOM SYMBOL LEGEND

- Triple (2 lower beds, 1 sofa bed)
- Quad (2 lower beds, 1 sofa bed, 1 upper)
- △ Partial sea view
- × Fully obstructed view
- + Connecting rooms
- * Shower only
- ♣ Single sink vanity, bathtub only
- ♠ Single sink vanity
- ◆ Staterooms have solid steel verandah railings instead of clear-view Plexiglas® railings
- ♿ Staterooms SA7058 and SA7057 are wheelchair accessible, bathtub and roll-in shower. Staterooms V8119, V8116, I-8033, V8026, V8025, VB6052, VB6049, VA6002, VA6001, VF5140, VF5135, VF5054, VF5051, SY5002, SY5001, VD4134, VD4131, H4092, H4089, VD4052, VD4051, D1100, D1099, C1082, C1081, J1074, N1012 & N1011 are wheelchair accessible, roll-in shower only.

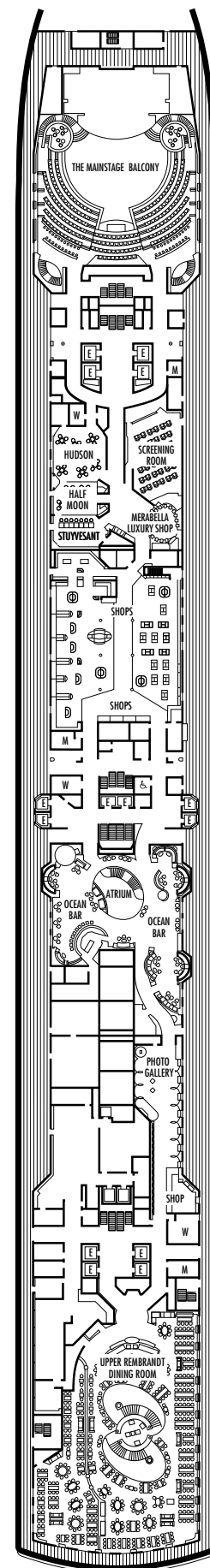
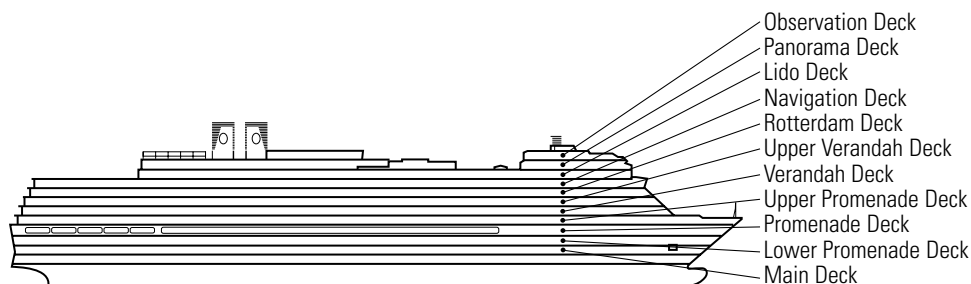

ms Eurodam

DECK PLANS & STATEROOMS

The deck plans are color-coded by category of stateroom, and the category letter precedes the stateroom number in each room. All staterooms are equipped with flat-panel television, mini-bar, DVD player, mini-safe, data port, telephone and multichannel music.

Important Note: Not all staterooms within each category have the same furniture configuration and/or facilities. Appropriate symbols within the rooms on the deck plans describe differences from the stateroom descriptions below.

All information is subject to change.

STATEROOM SYMBOL LEGEND

- Triple (2 lower beds, 1 sofa bed)
- Quad (2 lower beds, 1 sofa bed, 1 upper)
- △ Partial sea view
- × Fully obstructed view
- + Connecting rooms
- * Shower only
- ♣ Single sink vanity, bathtub only
- ♠ Single sink vanity
- ◆ Staterooms have solid steel verandah railings instead of clear-view Plexiglas® railings
- ♿ Staterooms SA7058 and SA7057 are wheelchair accessible, bathtub and roll-in shower. Staterooms V8119, V8116, I-8033, V8026, V8025, VB6052, VB6049, VA6002, VA6001, VF5140, VF5135, VF5054, VF5051, SY5002, SY5001, VD4134, VD4131, H4092, H4089, VD4052, VD4051, D1100, D1099, C1082, C1081, J1074, N1012 & N1011 are wheelchair accessible, roll-in shower only.

VERANDAH SUITES

SC

Neptune Suites: (Deluxe Verandah Suites)
2 lower beds convertible to 1 king-size bed, bathroom with dual-sink vanity, full-size whirlpool bath & shower & additional shower stall, large sitting area, dressing room, private verandah, 1 sofa bed for 2 persons, floor-to-ceiling windows. Approximately 506–590 sq. ft. including verandah.

VERANDAH STATEROOMS

VA VB VD VF VH

Verandah: (Deluxe Verandah Ocean-view)
2 lower beds convertible to 1 queen-size bed, bathtub & shower, sitting area, private verandah, floor-to-ceiling windows. Approximately 213–379 sq. ft. including verandah.

OCEAN-VIEW STATEROOMS

G GG

Large: 2 lower beds convertible to 1 queen-size bed, bathtub & shower. All G-category staterooms have partial sea views. All GG-category staterooms have fully obstructed views. Approximately 169–267 sq. ft.

H HH

Large: 2 lower beds convertible to 1 queen-size bed, bathtub & shower. All H- & HH-category staterooms have fully obstructed views. Approximately 169–267 sq. ft.

INTERIOR STATEROOMS

K

Large or Standard: 2 lower beds convertible to 1 queen-size bed, shower. Approximately 141–284 sq. ft.

M MM N

Standard: 2 lower beds convertible to 1 queen-size bed, shower. Approximately 141–284 sq. ft.

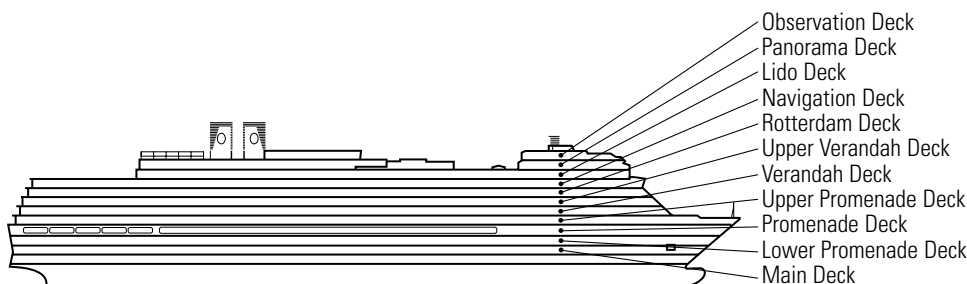

DECK 4—UPPER PROMENADE DECK

Staterooms 4001–4187

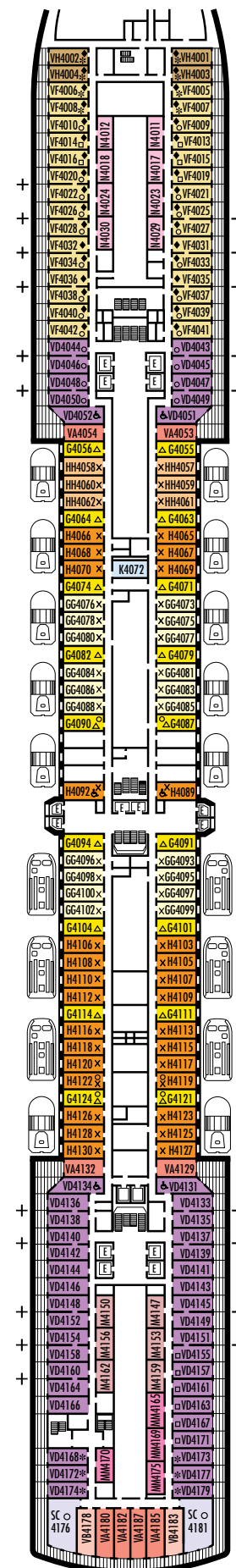

ms Eurodam

DECK PLANS & STATEROOMS

The deck plans are color-coded by category of stateroom, and the category letter precedes the stateroom number in each room. All staterooms are equipped with flat-panel television, mini-bar, DVD player, mini-safe, data port, telephone and multichannel music.

Important Note: Not all staterooms within each category have the same furniture configuration and/or facilities. Appropriate symbols within the rooms on the deck plans describe differences from the stateroom descriptions below.

All information is subject to change.

STATEROOM SYMBOL LEGEND

- Triple (2 lower beds, 1 sofa bed)
- Quad (2 lower beds, 1 sofa bed, 1 upper)
- △ Partial sea view
- × Fully obstructed view
- + Connecting rooms
- * Shower only
- ♣ Single sink vanity, bathtub only
- ♠ Single sink vanity
- ◆ Staterooms have solid steel verandah railings instead of clear-view Plexiglas® railings
- ♿ Staterooms SA7058 and SA7057 are wheelchair accessible, bathtub and roll-in shower. Staterooms V8119, V8116, I-8033, V8026, V8025, VB6052, VB6049, VA6002, VA6001, VF5140, VF5135, VF5054, VF5051, SY5002, SY5001, VD4134, VD4131, H4092, H4089, VD4052, VD4051, D1100, D1099, C1082, C1081, J1074, N1012 & N1011 are wheelchair accessible, roll-in shower only.

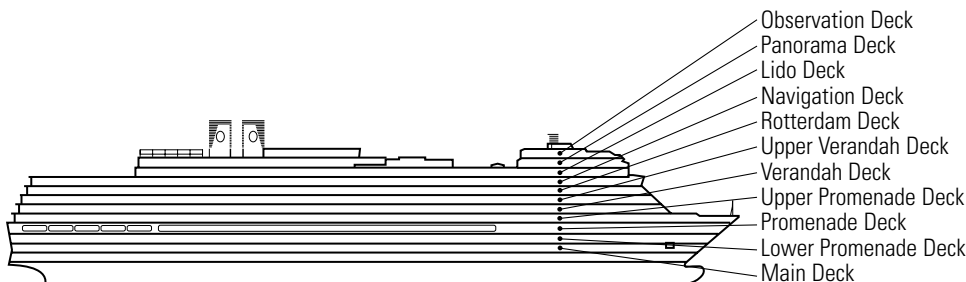

VERANDAH SUITES

SC

Neptune Suites: (Deluxe Verandah Suites)
2 lower beds convertible to 1 king-size bed, bathroom with dual-sink vanity, full-size whirlpool bath & shower & additional shower stall, large sitting area, dressing room, private verandah, 1 sofa bed for 2 persons, floor-to-ceiling windows. Approximately 506–590 sq. ft. including verandah.

SY SZ

Signature Suites: (Superior Verandah Suites)
2 lower beds convertible to 1 queen-size bed, bathroom with dual-sink vanity, full-size whirlpool bath & shower & additional shower stall, large sitting area, private verandah, 1 sofa bed for 1 person, floor-to-ceiling windows. Approximately 273–456 sq. ft. including verandah.

VERANDAH STATEROOMS

VA VC VE VF

Verandah: (Deluxe Verandah Ocean-view)
2 lower beds convertible to 1 queen-size bed, bathtub & shower, sitting area, private verandah, floor-to-ceiling windows. Approximately 213–379 sq. ft. including verandah.

INTERIOR STATEROOMS

I

Large: 2 lower beds convertible to 1 queen-size bed, shower. Approximately 141–284 sq. ft.

L

Standard: 2 lower beds convertible to 1 queen-size bed, shower. Approximately 141–284 sq. ft.

DECK 5 – VERANDAH DECK

Staterooms 5001–5193

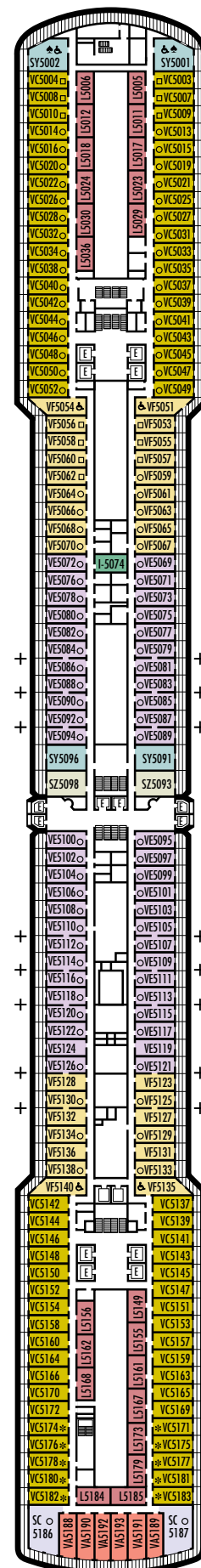

ms Eurodam

DECK PLANS & STATEROOMS

The deck plans are color-coded by category of stateroom, and the category letter precedes the stateroom number in each room. All staterooms are equipped with flat-panel television, mini-bar, DVD player, mini-safe, data port, telephone and multichannel music.

Important Note: Not all staterooms within each category have the same furniture configuration and/or facilities. Appropriate symbols within the rooms on the deck plans describe differences from the stateroom descriptions below.

All information is subject to change.

STATEROOM SYMBOL LEGEND

- Triple (2 lower beds, 1 sofa bed)
- Quad (2 lower beds, 1 sofa bed, 1 upper)
- △ Partial sea view
- × Fully obstructed view
- + Connecting rooms
- * Shower only
- ♣ Single sink vanity, bathtub only
- ♠ Single sink vanity
- ◆ Staterooms have solid steel verandah railings instead of clear-view Plexiglas® railings
- ♿ Staterooms SA7058 and SA7057 are wheelchair accessible, bathtub and roll-in shower. Staterooms V8119, V8116, I-8033, V8026, V8025, VB6052, VB6049, VA6002, VA6001, VF5140, VF5135, VF5054, VF5051, SY5002, SY5001, VD4134, VD4131, H4092, H4089, VD4052, VD4051, D1100, D1099, C1082, C1081, J1074, N1012 & N1011 are wheelchair accessible, roll-in shower only.

VERANDAH SUITES

SB SC

Neptune Suites: (Deluxe Verandah Suites)
2 lower beds convertible to 1 king-size bed, bathroom with dual-sink vanity, full-size whirlpool bath & shower & additional shower stall, large sitting area, dressing room, private verandah, 1 sofa bed for 2 persons, floor-to-ceiling windows. Approximately 506–590 sq. ft. including verandah.

SS

Signature Suites: (Superior Verandah Suites)
2 lower beds convertible to 1 queen-size bed, bathroom with dual-sink vanity, full-size whirlpool bath & shower & additional shower stall, large sitting area, private verandah, 1 sofa bed for 1 person, floor-to-ceiling windows. Approximately 273–456 sq. ft. including verandah.

VERANDAH STATEROOMS

VA VB

Verandah: (Deluxe Verandah Ocean-view)
2 lower beds convertible to 1 queen-size bed, bathtub & shower, sitting area, private verandah, floor-to-ceiling windows. Approximately 213–379 sq. ft. including verandah.

OCEAN-VIEW STATEROOMS

F

Large: 2 lower beds convertible to 1 queen-size bed, bathtub & shower. Approximately 169–267 sq. ft.

INTERIOR STATEROOMS

I

Large: 2 lower beds convertible to 1 queen-size bed, shower. Approximately 141–284 sq. ft.

K

Large or Standard: 2 lower beds convertible to 1 queen-size bed, shower. Approximately 141–284 sq. ft.

L

Standard: 2 lower beds convertible to 1 queen-size bed, shower. Approximately 141–284 sq. ft.

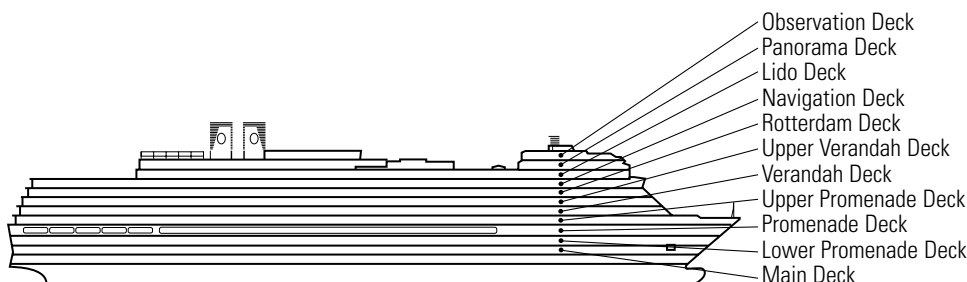

DECK 6 — UPPER VERANDAH DECK

Staterooms 6001–6181

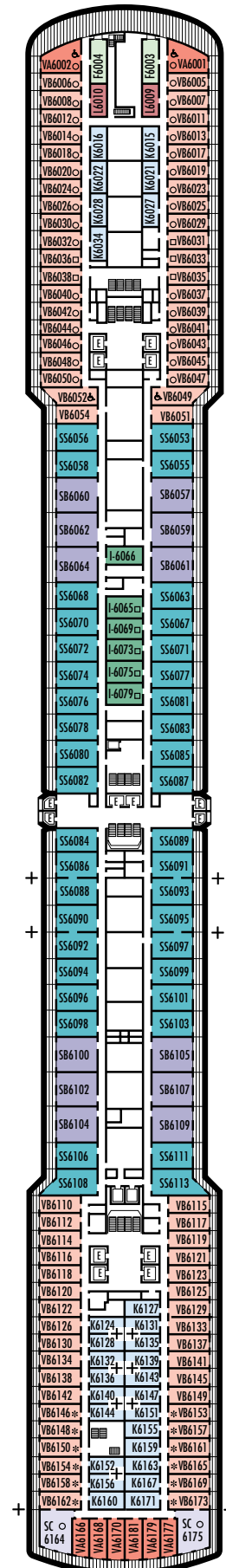

ms Eurodam

DECK PLANS & STATEROOMS

The deck plans are color-coded by category of stateroom, and the category letter precedes the stateroom number in each room. All staterooms are equipped with flat-panel television, mini-bar, DVD player, mini-safe, data port, telephone and multichannel music.

Important Note: Not all staterooms within each category have the same furniture configuration and/or facilities. Appropriate symbols within the rooms on the deck plans describe differences from the stateroom descriptions below.

All information is subject to change.

STATEROOM SYMBOL LEGEND

- Triple (2 lower beds, 1 sofa bed)
- Quad (2 lower beds, 1 sofa bed, 1 upper)
- △ Partial sea view
- × Fully obstructed view
- + Connecting rooms
- * Shower only
- ♣ Single sink vanity, bathtub only
- ♠ Single sink vanity
- ◆ Staterooms have solid steel verandah railings instead of clear-view Plexiglas® railings
- ♿ Staterooms SA7058 and SA7057 are wheelchair accessible, bathtub and roll-in shower. Staterooms V8119, V8116, I-8033, V8026, V8025, VB6052, VB6049, VA6002, VA6001, VF5140, VF5135, VF5054, VF5051, SY5002, SY5001, VD4134, VD4131, H4092, H4089, VD4052, VD4051, D1100, D1099, C1082, C1081, J1074, N1012 & N1011 are wheelchair accessible, roll-in shower only.

VERANDAH SUITES

PS

Pinnacle Suites: (Penthouse Verandah Suites)
Bedroom with 1 king-size bed, oversize whirlpool bath & shower & additional shower stall, living room, dining room, dressing room, private verandah with whirlpool, pantry, 1 sofa bed for 2 persons, microwave, refrigerator, guest toilet, private stereo system, floor-to-ceiling windows. Approximately 1,357 sq. ft. including verandah.

SA SB

Neptune Suites: (Deluxe Verandah Suites)
2 lower beds convertible to 1 king-size bed, bathroom with dual-sink vanity, full-size whirlpool bath & shower & additional shower stall, large sitting area, dressing room, private verandah, 1 sofa bed for 2 persons, floor-to-ceiling windows. Approximately 506–590 sq. ft. including verandah.

SS

Signature Suites: (Superior Verandah Suites)
2 lower beds convertible to 1 queen-size bed, bathroom with dual-sink vanity, full-size whirlpool bath & shower & additional shower stall, large sitting area, private verandah, 1 sofa bed for 1 person, floor-to-ceiling windows. Approximately 273–456 sq. ft. including verandah.

VERANDAH STATEROOMS

VA

Verandah: (Deluxe Verandah Ocean-view)
2 lower beds convertible to 1 queen-size bed, bathtub & shower, sitting area, private verandah, floor-to-ceiling windows. Approximately 213–379 sq. ft. including verandah.

INTERIOR STATEROOMS

J

Large or Standard: 2 lower beds convertible to 1 queen-size bed, shower. Approximately 141–284 sq. ft.

DECK 7 – ROTTERDAM DECK

Staterooms 7001–7143

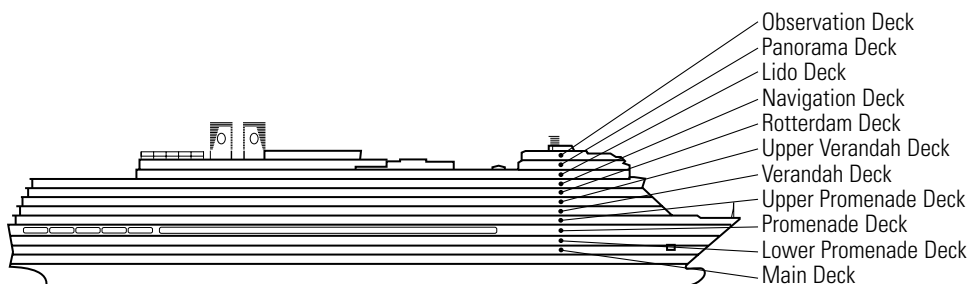
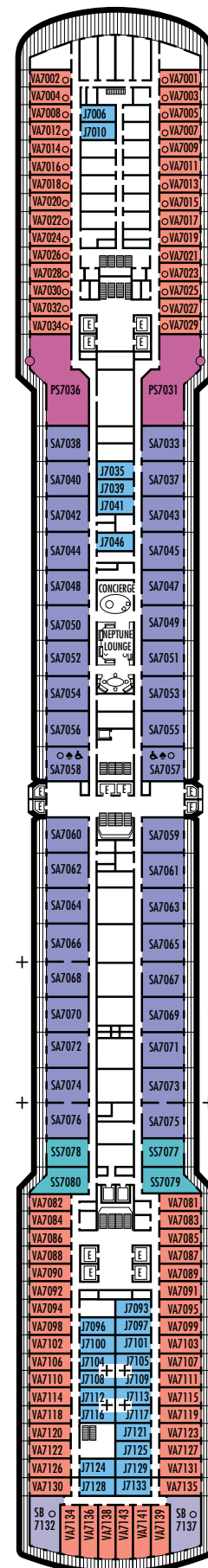

ms Eurodam

DECK PLANS & STATEROOMS

The deck plans are color-coded by category of stateroom, and the category letter precedes the stateroom number in each room. All staterooms are equipped with flat-panel television, mini-bar, DVD player, mini-safe, data port, telephone and multichannel music.

Important Note: Not all staterooms within each category have the same furniture configuration and/or facilities. Appropriate symbols within the rooms on the deck plans describe differences from the stateroom descriptions below.

All information is subject to change.

STATEROOM SYMBOL LEGEND

- Triple (2 lower beds, 1 sofa bed)
- Quad (2 lower beds, 1 sofa bed, 1 upper)
- △ Partial sea view
- × Fully obstructed view
- + Connecting rooms
- * Shower only
- ♣ Single sink vanity, bathtub only
- ♠ Single sink vanity
- ◆ Staterooms have solid steel verandah railings instead of clear-view Plexiglas® railings
- ♿ Staterooms SA7058 and SA7057 are wheelchair accessible, bathtub and roll-in shower. Staterooms V8119, V8116, I-8033, V8026, V8025, VB6052, VB6049, VA6002, VA6001, VF5140, VF5135, VF5054, VF5051, SY5002, SY5001, VD4134, VD4131, H4092, H4089, VD4052, VD4051, D1100, D1099, C1082, C1081, J1074, N1012 & N1011 are wheelchair accessible, roll-in shower only.

VERANDAH SUITES

SB

Neptune Suites: (Deluxe Verandah Suites)
2 lower beds convertible to 1 king-size bed, bathroom with dual-sink vanity, full-size whirlpool bath & shower & additional shower stall, large sitting area, dressing room, private verandah, 1 sofa bed for 2 persons, floor-to-ceiling windows. Approximately 506–590 sq. ft. including verandah.

VERANDAH STATEROOMS

V VA

Verandah: (Deluxe Verandah Ocean-view)
2 lower beds convertible to 1 queen-size bed, bathtub & shower, sitting area, private verandah, floor-to-ceiling windows. Approximately 213–379 sq. ft. including verandah.

INTERIOR STATEROOMS

I

Large: 2 lower beds convertible to 1 queen-size bed, shower. Approximately 141–284 sq. ft.

J

Large or Standard: 2 lower beds convertible to 1 queen-size bed, shower. Approximately 141–284 sq. ft.

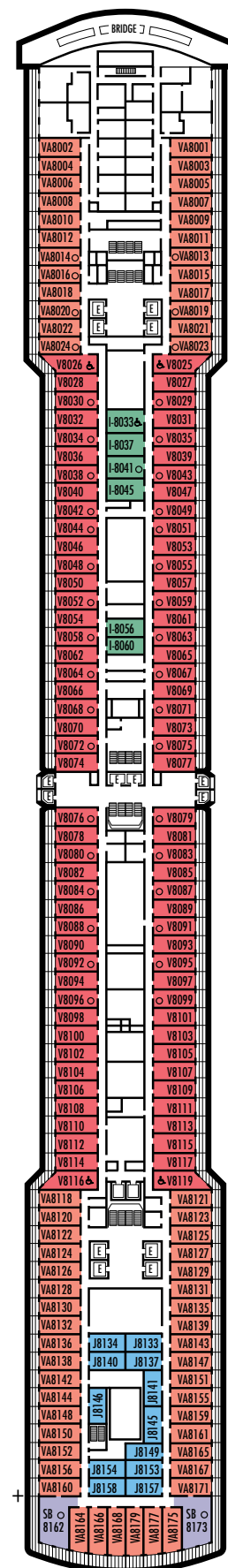
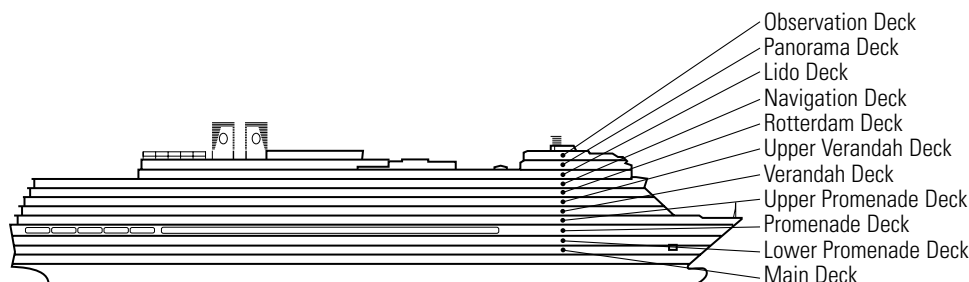

ms Eurodam

DECK PLANS & STATEROOMS

The deck plans are color-coded by category of stateroom, and the category letter precedes the stateroom number in each room. All staterooms are equipped with flat-panel television, mini-bar, DVD player, mini-safe, data port, telephone and multichannel music.

Important Note: Not all staterooms within each category have the same furniture configuration and/or facilities. Appropriate symbols within the rooms on the deck plans describe differences from the stateroom descriptions below.

All information is subject to change.

STATEROOM SYMBOL LEGEND

- Triple (2 lower beds, 1 sofa bed)
- Quad (2 lower beds, 1 sofa bed, 1 upper)
- △ Partial sea view
- × Fully obstructed view
- + Connecting rooms
- * Shower only
- ♣ Single sink vanity, bathtub only
- ♠ Single sink vanity
- ◆ Staterooms have solid steel verandah railings instead of clear-view Plexiglas® railings
- ♿ Staterooms SA7058 and SA7057 are wheelchair accessible, bathtub and roll-in shower. Staterooms V8119, V8116, I-8033, V8026, V8025, VB6052, VB6049, VA6002, VA6001, VF5140, VF5135, VF5054, VF5051, SY5002, SY5001, VD4134, VD4131, H4092, H4089, VD4052, VD4051, D1100, D1099, C1082, C1081, J1074, N1012 & N1011 are wheelchair accessible, roll-in shower only.

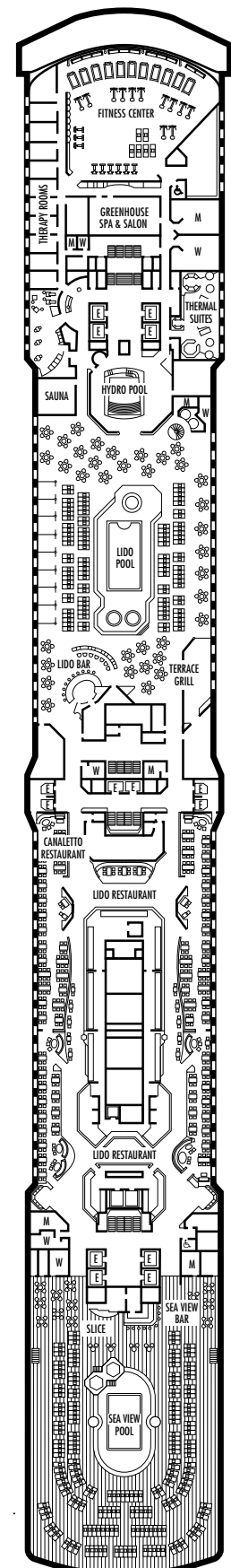
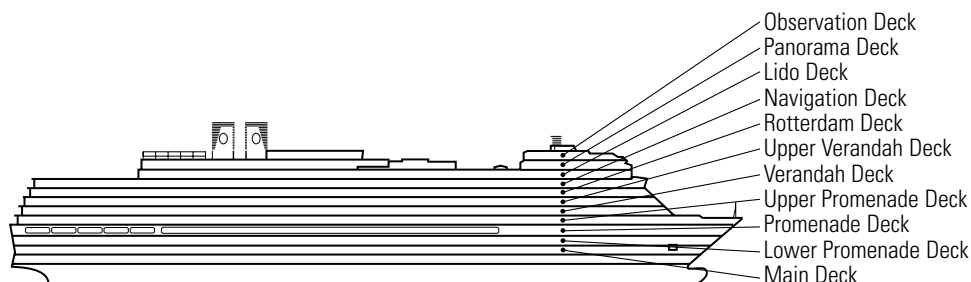

ms Eurodam

DECK PLANS & STATEROOMS

The deck plans are color-coded by category of stateroom, and the category letter precedes the stateroom number in each room. All staterooms are equipped with flat-panel television, mini-bar, DVD player, mini-safe, data port, telephone and multichannel music.

Important Note: Not all staterooms within each category have the same furniture configuration and/or facilities. Appropriate symbols within the rooms on the deck plans describe differences from the stateroom descriptions below.

All information is subject to change.

STATEROOM SYMBOL LEGEND

- Triple (2 lower beds, 1 sofa bed)
- Quad (2 lower beds, 1 sofa bed, 1 upper)
- △ Partial sea view
- × Fully obstructed view
- + Connecting rooms
- * Shower only
- ♣ Single sink vanity, bathtub only
- ♠ Single sink vanity
- ◆ Staterooms have solid steel verandah railings instead of clear-view Plexiglas® railings
- ♿ Staterooms SA7058 and SA7057 are wheelchair accessible, bathtub and roll-in shower. Staterooms V8119, V8116, I-8033, V8026, V8025, VB6052, VB6049, VA6002, VA6001, VF5140, VF5135, VF5054, VF5051, SY5002, SY5001, VD4134, VD4131, H4092, H4089, VD4052, VD4051, D1100, D1099, C1082, C1081, J1074, N1012 & N1011 are wheelchair accessible, roll-in shower only.

VERANDAH SPA SUITES

SU

Signature Spa Suites: (Superior Verandah Spa Suites) 2 lower beds convertible to 1 queen-size bed, bathroom with single-sink vanity, bath & shower, large sitting area, private verandah, 1 sofa bed for 1 person, floor-to-ceiling windows. Approximately 273–456 sq. ft. including verandah.

VERANDAH SPA STATEROOMS

VQ

Verandah Spa: (Deluxe Verandah Ocean-view Spa) 2 lower beds convertible to 1 queen-size bed, bathtub & shower, sitting area, private verandah, floor-to-ceiling windows. Approximately 213–379 sq. ft. including verandah.

OCEAN-VIEW SPA STATEROOMS

CA

Large Ocean-view Spa: 2 lower beds convertible to 1 queen-size bed, bathtub & shower. Approximately 169–267 sq. ft.

INTERIOR SPA STATEROOMS

IA

Standard Interior Spa: 2 lower beds convertible to 1 queen-size bed, shower. Staterooms IA10043 and IA10044 have fully obstructed windows. Approximately 141–284 sq. ft.

DECK 10 – PANORAMA DECK

Staterooms 10001–10046

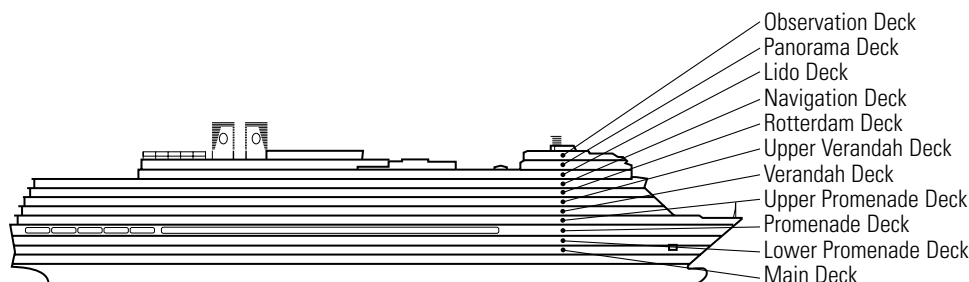
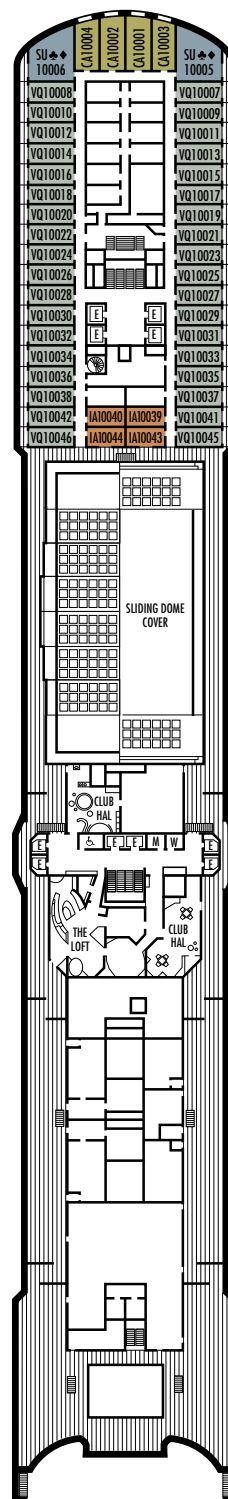

ms Eurodam

DECK PLANS & STATEROOMS

The deck plans are color-coded by category of stateroom, and the category letter precedes the stateroom number in each room. All staterooms are equipped with flat-panel television, mini-bar, DVD player, mini-safe, data port, telephone and multichannel music.

Important Note: Not all staterooms within each category have the same furniture configuration and/or facilities. Appropriate symbols within the rooms on the deck plans describe differences from the stateroom descriptions below.

All information is subject to change.

STATEROOM SYMBOL LEGEND

- Triple (2 lower beds, 1 sofa bed)
- Quad (2 lower beds, 1 sofa bed, 1 upper)
- △ Partial sea view
- × Fully obstructed view
- + Connecting rooms
- * Shower only
- ♣ Single sink vanity, bathtub only
- ♠ Single sink vanity
- ◆ Staterooms have solid steel verandah railings instead of clear-view Plexiglas® railings
- ♿ Staterooms SA7058 and SA7057 are wheelchair accessible, bathtub and roll-in shower. Staterooms V8119, V8116, I-8033, V8026, V8025, VB6052, VB6049, VA6002, VA6001, VF5140, VF5135, VF5054, VF5051, SY5002, SY5001, VD4134, VD4131, H4092, H4089, VD4052, VD4051, D1100, D1099, C1082, C1081, J1074, N1012 & N1011 are wheelchair accessible, roll-in shower only.

VERANDAH SPA STATEROOMS

VT

Verandah Spa: (Deluxe Verandah Ocean-view Spa) 2 lower beds convertible to 1 queen-size bed, bathtub & shower, sitting area, private verandah, floor-to-ceiling windows. VT staterooms have viewing balconies.
Approximately 213–379 sq. ft. including verandah.

DECK 11 – OBSERVATION DECK

Staterooms 11001–11010

